

# COVENT GARDEN HOTEL - Screening Room

The fully equipped state-of-the-art multi media screening room is of the highest professional standard and is luxuriously designed and fitted with 47 extremely comfortable red Italian leather seats. Comprehensive acoustic treatments ensure ideal internal viewing conditions, free from external intrusions.

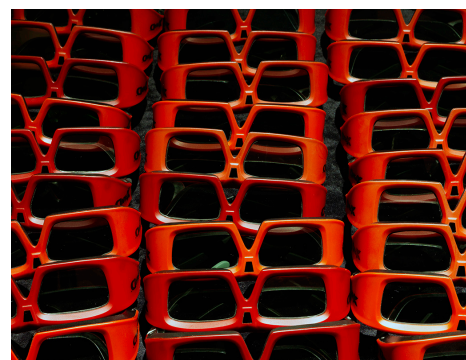
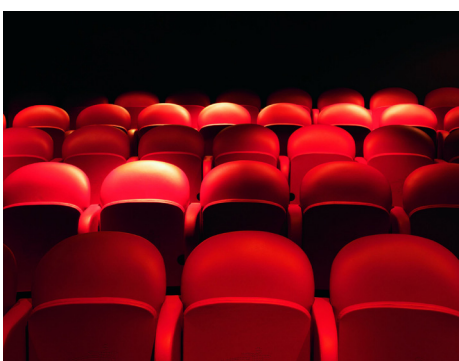

## Room Specifications & Rates

**SEATS** - 47

**SCREEN** - 4.30 x 1.88m

**RATES** - £240 per hour

Additional fee £120 for 3D screenings  
(2 hour minimum for all screenings)

### TECHNICAL SPECIFICATIONS

DCinema Barco DPI 200 2K Digital Cinema Projector  
 DoReMi DCP2k server  
 Xpand Active 3D technology  
 Kramer VP-747 Switcher / Scaler  
 Denon DN-500BD Blu-ray Player  
 Digi Beta, Sony J 30  
 DVD player, Pioneer Multi Region  
 Sky HD  
 CD Player  
 2 HDMI connections at stage (Connect Xbox, Playstation etc includes 5.1 sound)  
 VGA connection at stage for MAC & PC

### SOUND EQUIPMENT

Dolby CP750 cinema processor  
 Datasat AP20 audio processor  
 QSC900 / 1310 power amplifiers  
 THD 1138 crossover monitor unit  
 Three stage speakers JBL3678  
 Eight Martin Audio surround speakers  
 Sub bass KCS215  
 Acoustically transparent masking  
 Sound Formats Supported  
 Dolby 7.1, 5.1  
 Microphones, wired and wireless, hand held and lapel  
 Stage Connectivity  
 HDMI and VGA  
 XLR line sockets (adaptor to 3.5mm for PC)

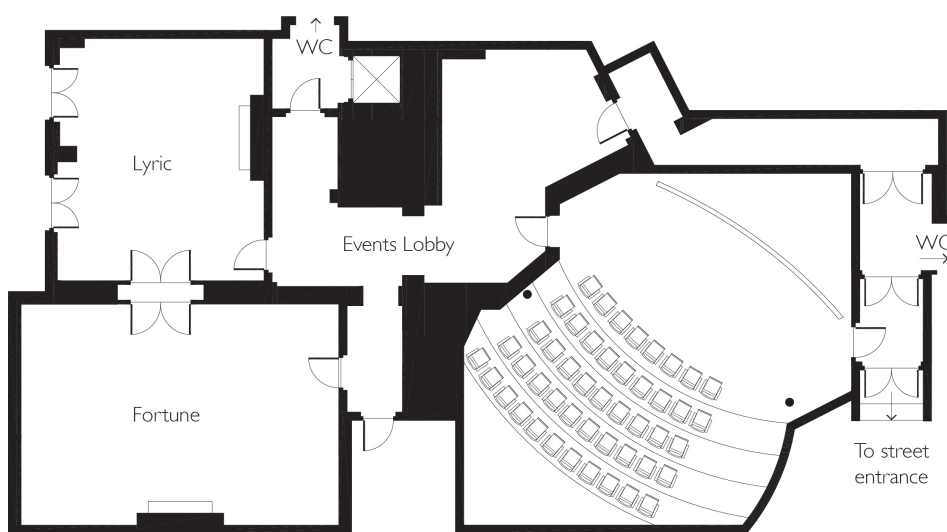

### EQUIPMENT

Lectern and microphone	£100 per day
Clip radio microphone	£65 per day
Hand held radio microphone	£65 per day
Table-top microphone	£65 per day
Lost or broken 3D glasses	£20 per pair
Audio Distribution Board	£120 per day
Solid State Audio Recorder	£200 per day
Video Format Decks	
DVCAM, HDDV, XDCAM	£300 per day
HDCAM SR/ D5	£550 per day
Hard wired internet access	£100 per day
WiFi complimentary	
Additional technical support	£450 per day
All prices are inclusive of VAT	

### MENU

Fish and chip cones	£5.00
Mini hot dogs	£5.00
Mini cheese burgers	£5.00
Popcorn	£4.00
Selection of crisps (40g)	£1.50
Selection of sweets	£4.00
Selection of nuts	£4.00
Pop by Pommery (200ml)	£16.50
Selection of bottled beers (330ml)	£6.00
Evian water (500ml)	£3.50
Selection of bottled juices (250ml)	£4.00
Selection of soft drinks (330ml)	£3.75
Classic POP	£7.00
Bellini POP	£7.00
Strawberry and Mint POP	£4.00
Apple and Elderflower POP	£4.00
Selection of mini ice cream tubs (100ml)	£4.00